

Installation manual
Alto LED / Alto LED DI-IN

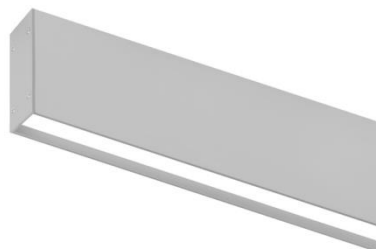

220-240V 50/60Hz

1. Dimensions:

L [mm]	Weight DI / DI-IN [kg]	A
545	1,3 / 1,3	325
1085	2,3 / 2,4	865
1625	3,3 / 3,4	1405
2170	4,4 / 4,5	1950

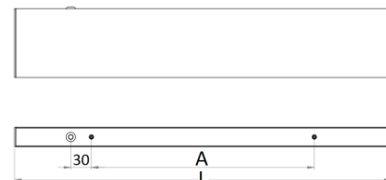
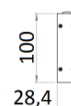
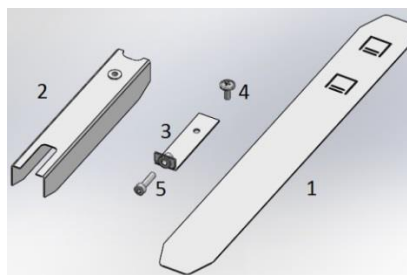

Assembly parts for linear joining (accessories)

2. Installation:

- a) Turn off the power supply in the circuit.
- b) Install the suspensions set in the ceiling accordingly to the mounting holes dimensions
- c) Take the luminaire out of the packaging.

Single mounting:

- 1) Remove the cover/ upper diffuser from the luminaire.
- 2) Slide out the gear tray with the connection terminal (so it's visible) (Fig. 1)
- 3) Connect the power cable to the luminaire, threading it through the K inlet as shown in the fig. 5
- 4) Slide the gear tray back into the luminaire so the connector is even with the Edge of the luminaire (Fig. 3)
- 5) Using a 7mm key wrench, tighten the nut on the top of the luminaire (Fig. 4)
- 6) Thread the wires and power cable through the holes in the cover, put the wires in the tension regulators in the luminaire. Choose the height at which the luminaire should be installed.
- 7) Click the cover/ upper diffuser back in the luminaire.
- 8) Install the end caps.

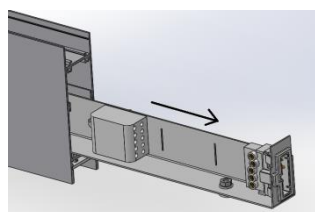

Fig.1

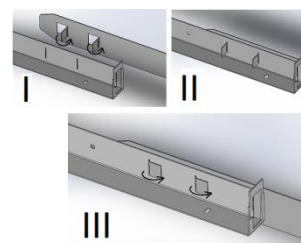

Fig.2

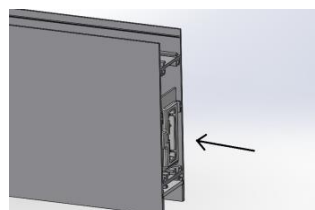

Fig.3

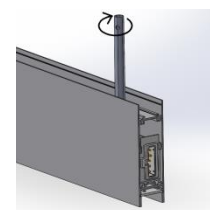

Fig.4

Linear installation:

- 1) Remove the cover/ upper diffuser from the luminaire
- 2) Slide out the gear tray with the connection terminal (so it's visible) (Fig. 1)
- 3) Place the assembly part no.1 in the slots (Fig. 2)
- 4) Connect the power supply to the luminaire (optional) threading it through K inlet as shown in the fig. 5
- 5) Slide the gear tray back into the luminaire so the connector is even with the Edge of the luminaire
- 6) Using a 7mm key wrench, tighten the nut on the top of the luminaire (Fig. 4)
- 7) Slide the installation piece no. 2 so the thread is visible in the inlet (Fig. 5)
- 8) Slide the installation piece no. 3, screw in a no. 4 M4 (Fig. 6)
- 9) Thread the wires and power cable (optional*) through the holes in the cover/ upper diffuser, put the wires in the tension regulators in the luminaire. Choose the height at which the luminaire should be installed.
- 10) Pull out the through-wiring connector from the other luminaire, connect it to the already installed one (Fig.7)
- 11) Join the luminaires together (Fig. 8), twist a screw no.5 in, regulate the length of the suspension.
- 12) Click the cover/ upper diffuser back in the luminaire.
- 13) Install the end caps.

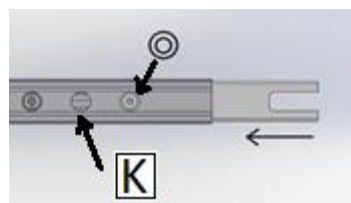

Fig.5

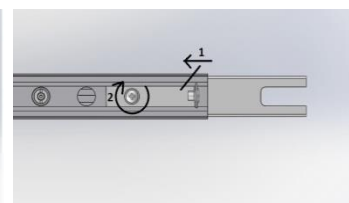

Fig.6

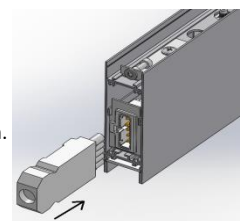

Fig.7

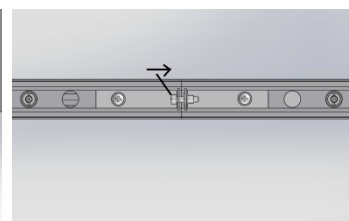

Fig.8

3. Important warnings:

- the luminaires may be installed by qualified registered personnel only,
- any manipulation inside the luminaire when the power is activated causes the risk of electric shock,
- the manufacturer is not responsible for any flaws resulting from non-compliance with these instructions,
- the manufacturer reserves the right to change the construction of the product,
- do not install the luminaire in places without sufficient air circulation,
- to guarantee safe luminaire functioning, please follow the instructions in the installation instructions.



The European Directive 2002/96/EC on waste electrical and electronic equipment, requires that electric and electronic devices must be disposed of in the normal household waste. The crossed out wheeled bin is reproduced in order to remind obligations towards separate collection. For correct disposal, please use authorized waste disposal facilities or return to the distributor at the date a new lighting fitting is purchased. Lamps, if disposed together with the lighting fitting, shall not be broken up since they contain substances which are highly polluting to the environment. Unauthorized disposal of the foregoing waste material is punishable by law.

