

Installation manual
Quaset LED

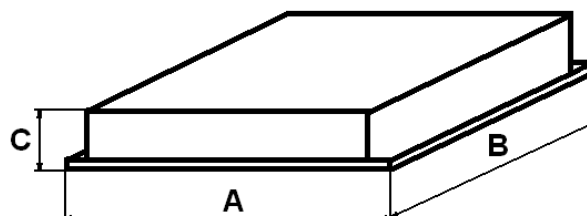
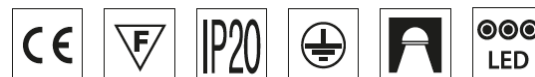

220-240V/50-60Hz

1. Dimensions and weight

Power [W]	A	B	C	Cut-out size	Weight [kg]
32, 47	596	596	50	580x580	3,9

2. Installation

- a) carefully remove the luminaire from the packaging and place it on a stable surface
- b) in case of **recessed** installation, while using gloves, carefully remove the louvers and install the springs*
- c) connecting to the power supply:
 - thread the power cord through the hole in the base of the luminaire
 - bend the steel part holding the connection terminal
 - connect the wires accordingly to the scheme on the terminal
 - bend the steel part back to its original position
- d) install the luminaire in the ceiling

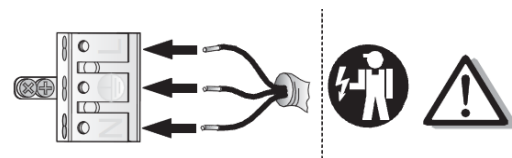

*** springs installation**

- springs should be put into the longitudinal holes
- block the springs with "T" parts inside the luminaire

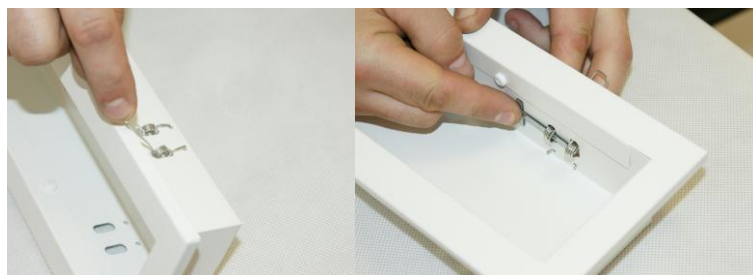

3. Important warnings:

The manufacturer cannot be considered liable for any damages deriving from improper, wrong and unreasonable use of the fitting.

Luminaires may be installed by qualified personnel only.

Any manipulation inside the luminaire when power supply is on causes the risk of electric shock.

Manufacturer is not responsible for any flaws caused by avoid using this manual.

Manufacturer reserves a right to change the construction of the product.

Do not assembly in places without air circulation.

To guarantee safety of fixture functions, please assembly according to instruction.



The European Directive 2002/96/EC on waste electrical and electronic equipment, requires that electric and electronic devices must be disposed of in the normal household waste. The crossed out wheeled bin is reproduced in order to remember obligations towards separately collection. For correct disposal, please use authorized waste disposal facilities or returned to the distributor at the date a new lighting fitting is purchased. Lamps, if disposed together with the lighting fitting, shall not be broken up since they contain substances which are highly polluting for the environment. Unauthorized disposal of the foregoing waste material is punishable by law.

