

Installation manual  
**Sigma G/K LED Trimless**



220-240V/50-60Hz

**1. Dimensions:**

Power [W]	Length L [mm]	Suspension spacing A [mm]	Cut out dimensions including end caps [mm]	Weight [kg]
13	545	485	60x551	1,6
25	1085	855	60x1091	2,7
36	1625	1395	60x1631	3,6
48	2170	1940	60x2176	5,3

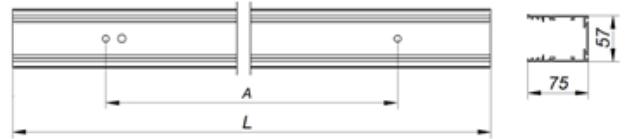

**2. Installation:**

- a) Turn off the power in the circuit;
- b) Carefully take the luminaire out of the package;
- c) Pull out the diffuser and LED module;
- d) Using the template (available as accessory) cut out the installation hole (fig.1-3);



ATTENTION!

In case of a few luminaires connected into Light-line lengths need to be summed up with 6mm added on top of it. i.e.: cut-out for line SIGMA G/K LED Trimless 545 + SIGMA G/K LED Trimless 1085 = 545+1085+6 = 1636mm.

- e) Space the mounting brackets accordingly to the table, fix the brackets to the ceiling (fig.4-5);
- f) Finish the ceiling (fig.6-11);
- g) Put the power cable in the luminaire;
- h) Install the fixture, install „U” brackets and by screwing the bolts adjust the position of the fitting (fig.12-14);
- i) Connect the power cable to the power connector accordingly to the markings (fig on the right);
- j) connect the LED module and install it in the fixture (fig.15-16);
- k) Click the diffuser in the fitting (fig.17)

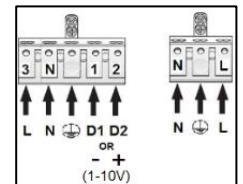

ATTENTION:

- luminaires in Light lines should be joined with linear connectors
- end caps should be fixed on the ends of the run

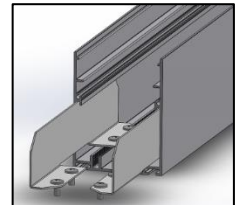

**Light line installation:**

Assembly into line starts with pushing the linear connectors into the first luminaire.

Next, push the other luminaire in and move the connectors so it's even on both sides and tighten the screws.

Connect the through-wiring fast connectors and connect one of the luminaires to power.

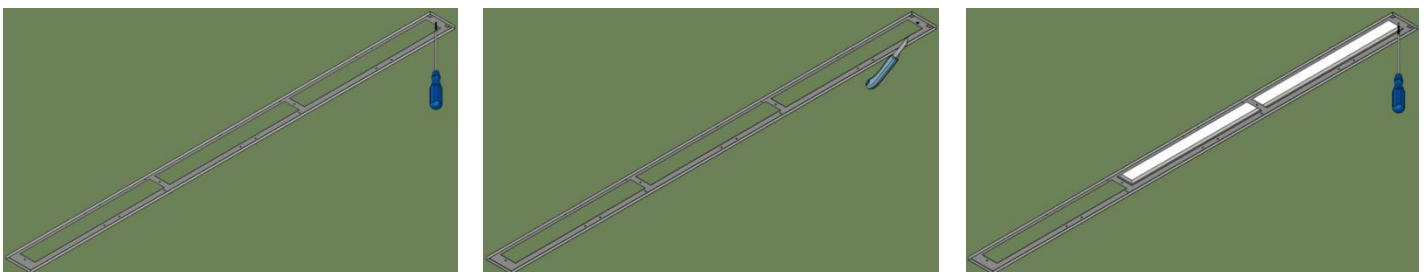

Fig.1-3 Assembly and dis-assembly of the template

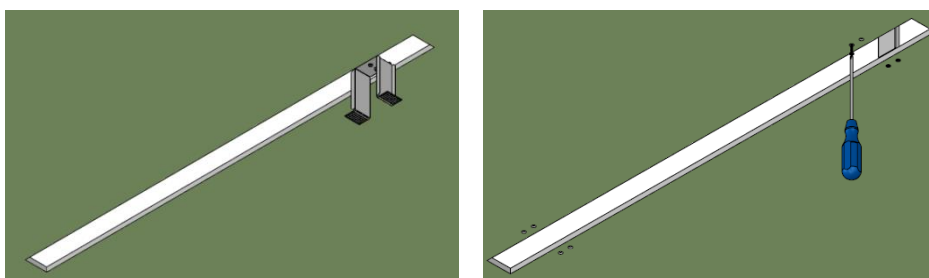

Fig.4-5 Brackets installation

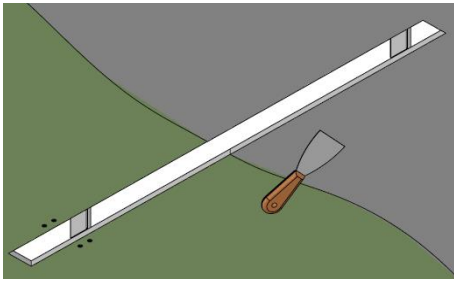

Fig. 6-7 Plasterboard finish

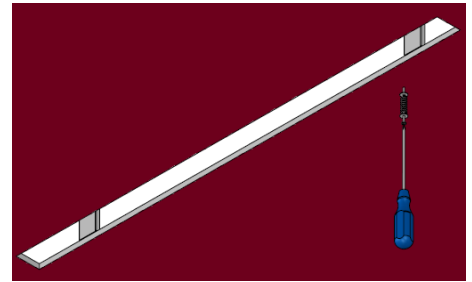
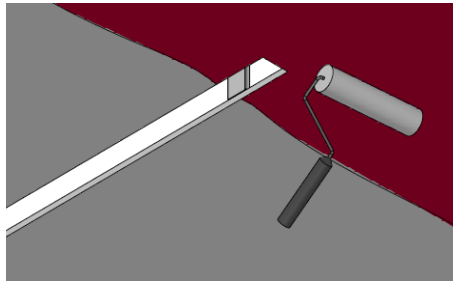

Fig. 8 Fixing bolts installation

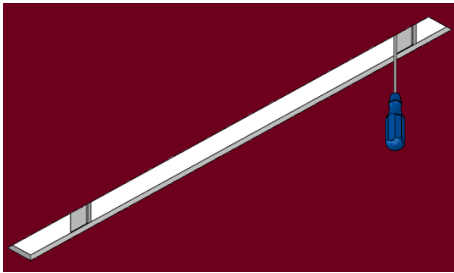

Fig. 9-11 Fixing bolts installation

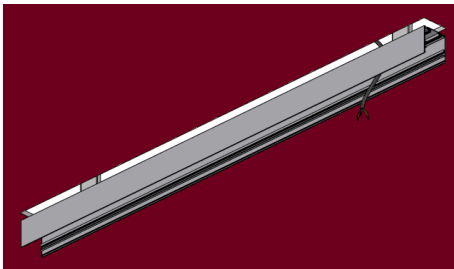
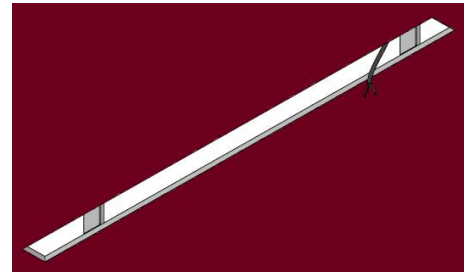
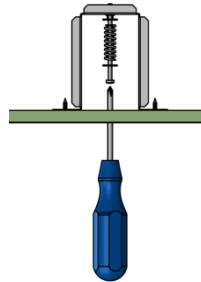

Fig. 12-13 Fixture installation

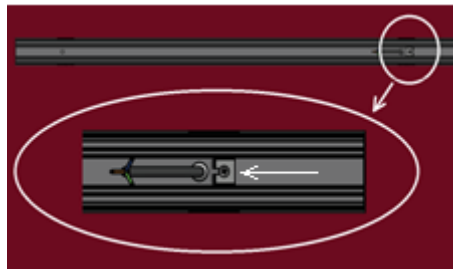

Fig. 14 Adjustment of the position

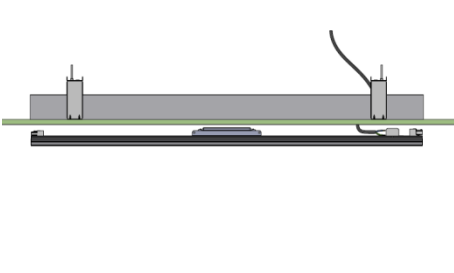
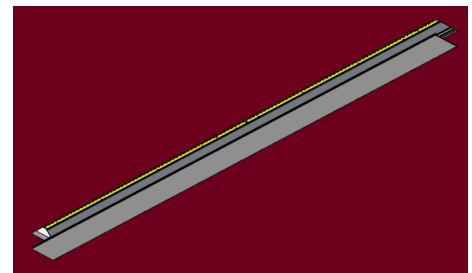
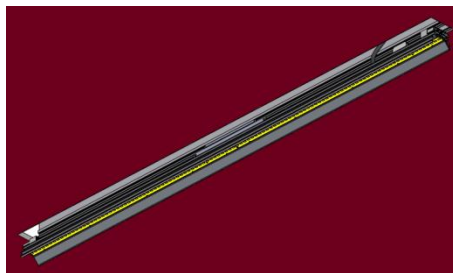

Fig. 15-17 LED module and diffuser installation



**3. Important warnings:**

The manufacturer cannot be considered liable for any damages deriving from improper, wrong and unreasonable use of the fitting. Luminaires may be installed by qualified personnel only.  
 Any manipulation inside the luminaire when power supply is on causes the risk of electric shock.  
 Manufacturer is not responsible for any flaws caused by avoid using this manual.  
 Manufacturer reserves a right to change the construction of the product.  
 Do not assembly in places without air circulation.

To guarantee safety of luminaire functions, please assembly according to instruction.  
 The European Directive 2002/96/EC on waste electrical and electronic equipment, requires that electric and electronic devices must not be disposed of in the normal household waste. The crossed out wheeled bin is reproduced in order to remind obligations towards separate collection. For correct disposal, please use authorized waste disposal facilities or return to the distributor at the date a new lighting fitting is purchased. Lamps, if disposed together with the lighting fitting, shall not be broken up since they contain substances which are highly polluting to the environment. Unauthorized disposal of the foregoing waste material is punishable by law.

