



**Installation manual**  
**VIP GK LED CORNER**



**220-240V/50-60Hz**  
**LED**

Power [W]	Weight [kg]
31	3,0 kg

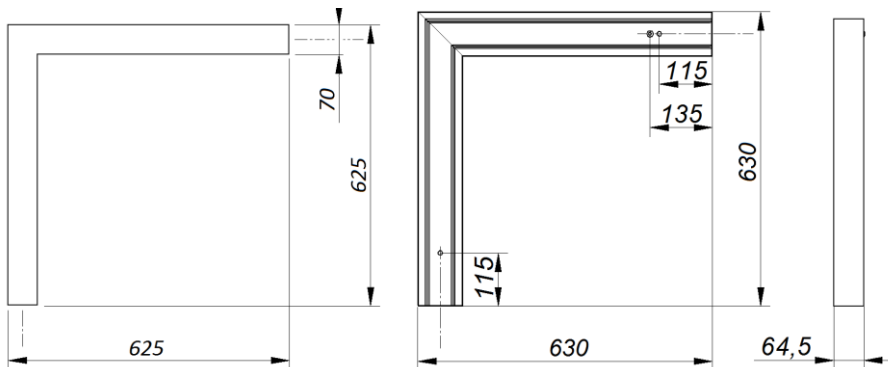

Dimensions of the installation hole

Dimensions of the luminaire

- a) Turn off the power in the circuit which the luminaire is going to be connected to.
  - b) Carefully take the luminaire out of the package.
  - c) Slide out the diffuser and detach the LED module fixed with magnets.
  - d) Cut out an installation hole in the ceiling and set up the installation brackets on it.
- ATTENTION!**



In case of several luminaires connected in a line, sum up all the lengths of the luminaires and add 10mm to the result. For example: a cut-out for a line VIP G/K LED CORNER 630 + VIP G/K LED 1455 = 630+1455+10 = 2095mm

- e) Pull the power cable through the hole in the luminaire.
- f) Put the bracket screws into the holes in the luminaire and tighten them to fix the luminaire to the ceiling
- g) Connect the power cable to the connection terminal in the luminaire as indicated on the markings.
- h) Connect the LED source wires to the connection blocks in the luminaire as indicated on the figure below.
- i) Pay extra attention to the polarity while connecting the wires.  
 (ATTENTION: Reverse connection may result in damage to the LED sources.)
- j) Attach the plate with the LED module back.
- k) Click the diffuser into the groove in the luminaire.

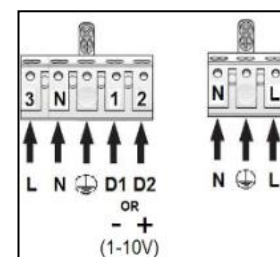

- ATTENTION:**
- use linear joints to connect the luminaires in line
  - The screws should be tightened without using too much force not to cause any deformation to the profile.
  - attach the end caps at the ends of a light line.

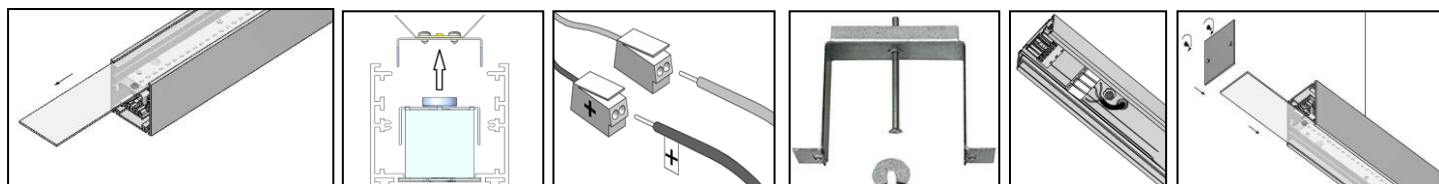

**Important warnings:**

The luminaires may be installed by qualified registered personnel only. Any manipulation inside the luminaires when the power is activated causes the risk of electrical shock.

The manufacturer is not responsible for any flaws resulting from non-compliance with these instructions. The manufacturer reserves the right to change the construction of the luminaire. Do not install the luminaire in places without sufficient air circulation. To guarantee safe luminaire functioning, please follow the installation instructions.



The European Directive 2002/96/EC on waste electrical and electronic equipment, requires that electric and electronic devices must not be disposed of in the normal household waste. The crossed out wheeled bin is reproduced in order to remind obligations towards separate collection. For correct disposal, please use authorized waste disposal facilities or return to the distributor at the date a new lighting fitting is purchased. Lamps, if disposed together with the lighting fitting, shall not be broken up since they contain substances which are highly polluting to the environment. Unauthorized disposal of the foregoing waste material is punishable by law.

