

INSTALLATION MANUAL

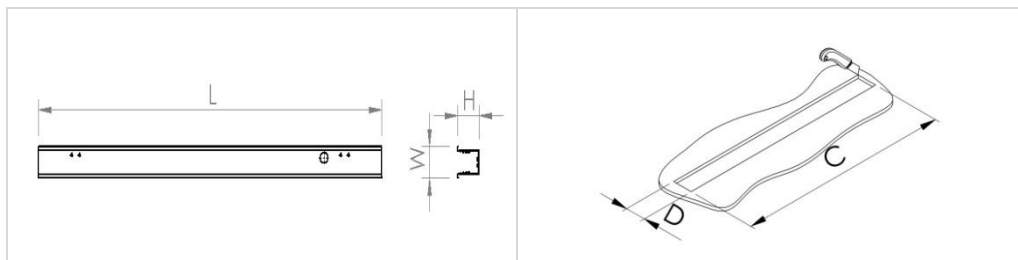

VIGO GK LED



Power [W]	L [mm]	W [mm]	H [mm]	Opening cut-out dimensions for a single CxD profile	Weight Opal / MPRM / PAR [kg]
15	560	56	54	570x53	1,20 / 1,20 / 1,10
21	840	56	54	850x53	1,50 / 1,50 / 1,45
28	1120	56	54	1130x53	1,95 / 1,95 / 1,75
35	1400	56	54	1410x53	2,35 / 2,35 / 2,15
42	1680	56	54	1690x53	2,80 / 2,80 / 2,45
48	1960	56	54	1970x53	3,20 / 3,20 / 2,80
55	2240	56	54	2250x53	3,60 / 3,60 / 3,15

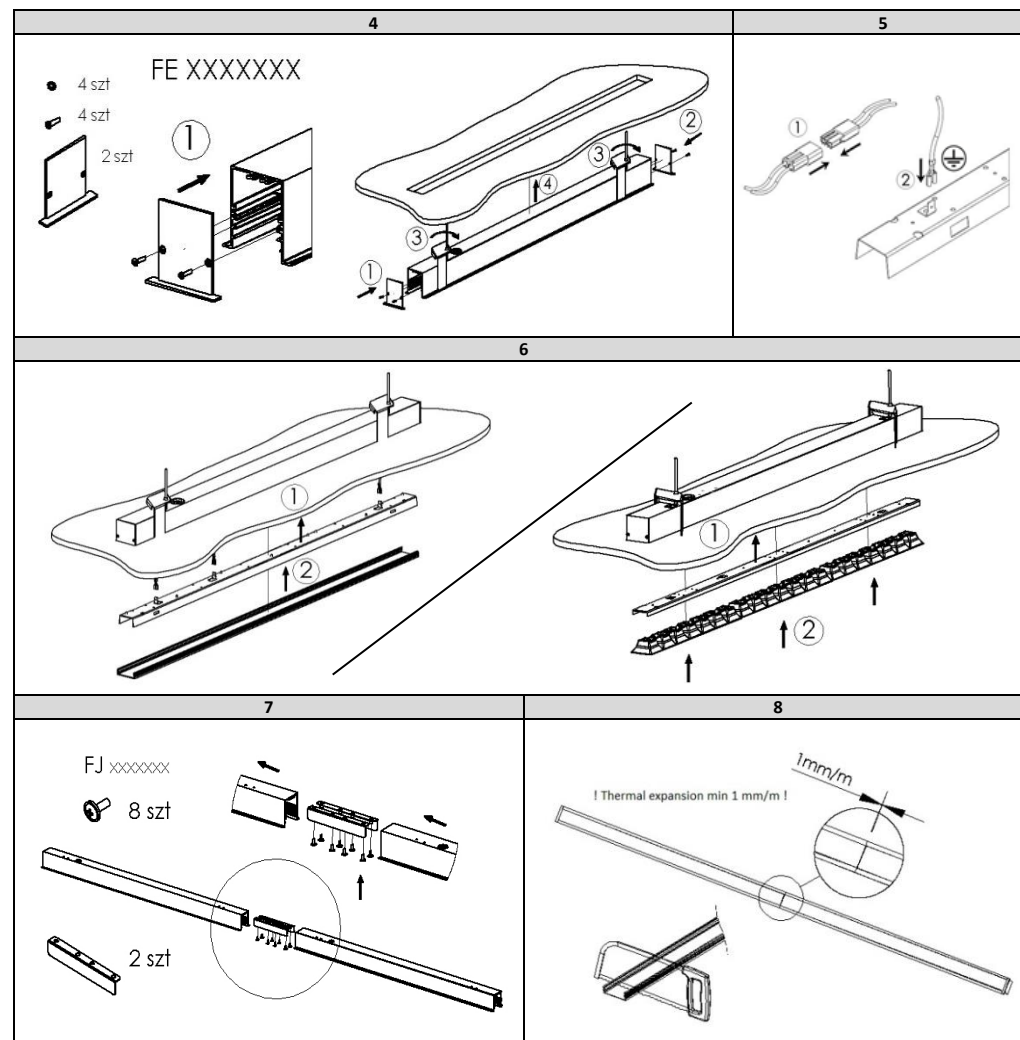
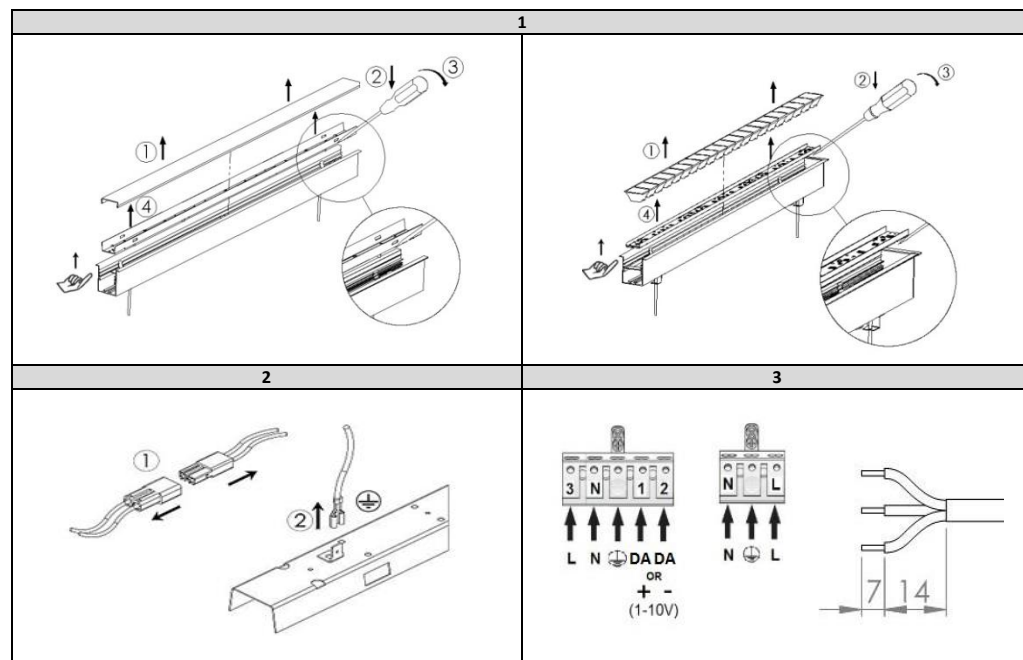

Light source used in this luminaire should be changed by the producer or its service representative or similarly qualified person. Installation kit supplied with the luminaire does not include anchors for ceiling installation. Installation kit supplied with the luminaire does not include anchors for ceiling installation..

Classification of insulation maintained between LV power supply and control cables - basic insulation. Provide basic insulation between the LV power supply and control cables.

Maximum load for through wiring 6A.

Important warnings:

The luminaires may be installed by qualified registered personnel only.

Any manipulation inside the luminaire when the power is activated causes the risk of electric shock.

The manufacturer is not responsible for any flaws resulting from non-compliance with these instructions.

The manufacturer reserves the right to change the construction of the product.

Do not install the luminaire in places without sufficient air circulation.

To guarantee safe luminaire functioning, please follow the instructions in the installation instructions.

PXF Lighting website: www.pxf.pl



The European Directive 2002/96/EC on waste electrical and electronic equipment, requires that electric and electronic devices must be disposed of in the normal household waste. The crossed out wheeled bin is reproduced in order to remind obligations towards separate collection. For correct disposal, please use authorized waste disposal facilities or return to the distributor at the date a new lighting fitting is purchased. Lamps, if disposed together with the lighting fitting, shall not be broken up since they contain substances which are highly polluting to the environment. Unauthorized disposal of the foregoing waste material is punishable by law.



Caution, risk of electric shock!