

Assembly instruction Kardo Mini 1x

Assembly instruction:

1. Please cut off the electrical source before installation.
2. Please preserve some room and dissipation hole for fixture installation and heat dissipation.
3. Take off the inner trim, Remove the top housing cover, then connector the power line as Fig 1.
4. Fix the fitting on the ceiling with the spring as Fig 2.
5. Put the lamp source into the socket, fix the lamp source into the inner trim spring as Fig 3.
6. Put the inner trim on the fitting as Fig 4.

230-240V/50Hz



Important warnings:

- Do not install the fixtures in areas without an exchange of air.
- The manufacturer cannot be considered liable for any damages deriving from improper, wrong and unreasonable use of the fitting.
- Luminaries may be installed by qualified personnel only.
- Any manipulation inside the luminary when power supply is on causes the risk of electric shock.
- Manufacturer is not responsible for any flaws resulting from not complying with recommendations included in this instruction manual.
- Manufacturer reserves a right to change the construction of the product.

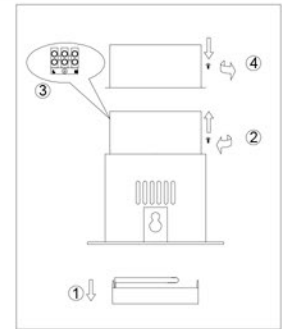
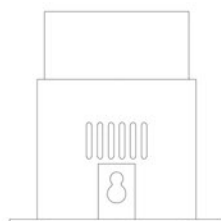
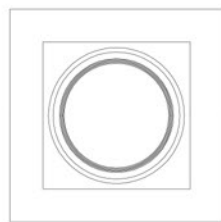

Fig.1

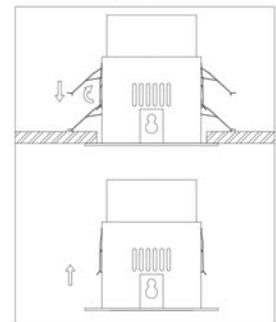

Fig.2

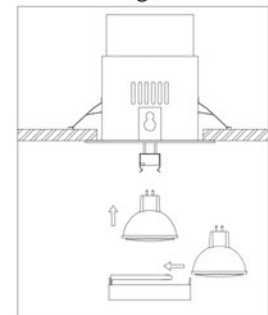

Fig.3

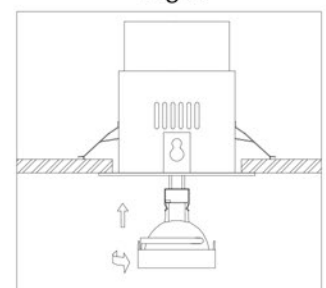

Fig. 4

The European Directive 2002/96/EC on waste electrical and electronic equipment, requires that electric and electronic devices must be disposed of in the normal household waste. The crossed out wheeled bin is reproduced in order to remember obligations towards separately collection. For correct disposal, please use authorized waste disposal facilities or returned to the distributor at the date a new lighting fitting is purchased. Lamps, if disposed together with the lighting fitting, shall not be broken up since they contain substances which are highly polluting for the environment. Unauthorized disposal of the foregoing waste material is punishable by law. More details of directive available at: <http://www.gios.gov.pl>

